



## Assembly instructions for Arlo-Micromodel CP B&L 1200 kit

Thank you for purchasing our kit. We hope you will enjoy to model your **Brissoneau & Lotz CP class 1200, diesel locomotive**. This kit is produced to easily fit **BB-63000 SNCF models from Piko**. Please note that, like other similar resin cast kits, this will require some more advanced modelling techniques and skills.

### I- Included parts:



- 1- Cast bodyshell
- 2- Cabin roof
- 3- Cast side foot step ladders
- 4- Front and rear buffer plates
- 5- Transparent front and rear vacform parts and plain styrene for side windows
- 6- Cast buffers
- 7- Bogie new roller bearing covers
- 8- Front finishing foot plates
- 9- Upper vent cover (not shown)

## II - Some of the required tools for modeling the kit:



- 1- Cutter
- 2- Drill - 0,3 e 0,5 mm.
- 3- Set of various shape files
- 4- Sand paper of various grain types for hard thinning of surfaces and smooth finishing touches
- 5- Bending and cutting plyers
- 6- Good quality cianoacrylate glue.
- 7- Quality Primer and paints like Revell/Tamiya ones, Fast drying putty filler
- 8- Mini drill station
- 9- Masking tape or fluid to your choice

### III - Preparing the parts for primer coating ( Sample pics from our EE 1400 kit):

1-



- Remove all the window flash.

2-



- Filling of small gaps and bubbles, and correcting work of eventual imperfections.

3- Putty sanding and smoothing as required.

4- Adjusting of the various transparent parts. After adjustment, you may choose to fix them definitively before or after painting, using a toothpick with a small drop of transparent-dry white glue or crystal fix from Humbrol or similar. The clear styrene will be used for the side windows.

When choosing to place all these parts before painting, be sure of masking them carefully.

Note: Our Vacuum-formed clear parts are polycarbonate made. This material is resistant to most solvents without damage . However you may test clean in a small spare cut.

Sample pics are from our EE 1400 kit



#### IV - General assembly

- 1- After these procedures are done, it's time to prepare the chosen Piko BB-63000 locomotive and start the disassembling procedures as mentioned in the original instructions.

After removing the cabin, remove the plastic decoder cover plate. The original main body shell is fixed by a single main screw, located inside the underframe plastic housing.

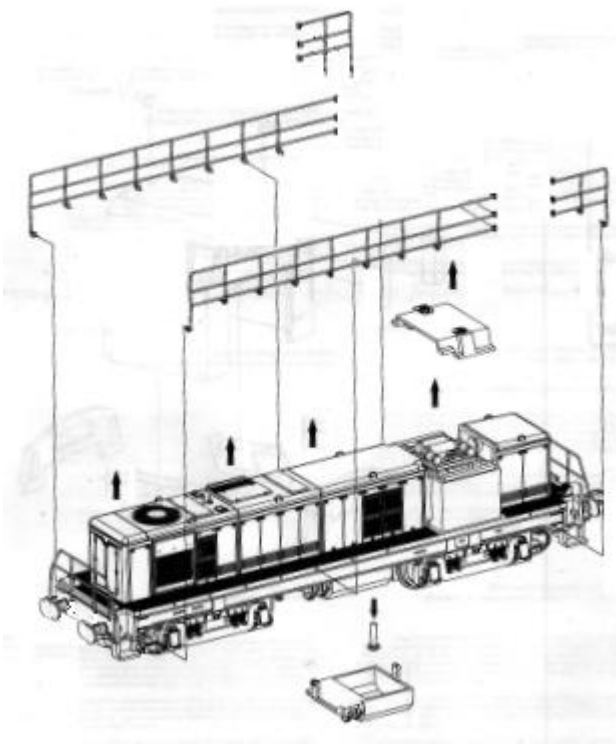

Decoder plate to be removed

Main body fixing screw located inside the plastic housing

- 2- Carefully loose the SMD-Led plates from their place without removing the wiring, as these parts will fit perfectly on new location behind the new headlights. You will find that this task won't be too complicated. The only requirement will be the correct tune-positioning of the white SMD's to the corresponding headlights, making sure all inner body shell headlight surrounding areas will be painted opaque black, avoiding the annoying effect of light diffusion through the resin cast body.

3- In this drawing, you will find the kit parts that will replace the original ones:

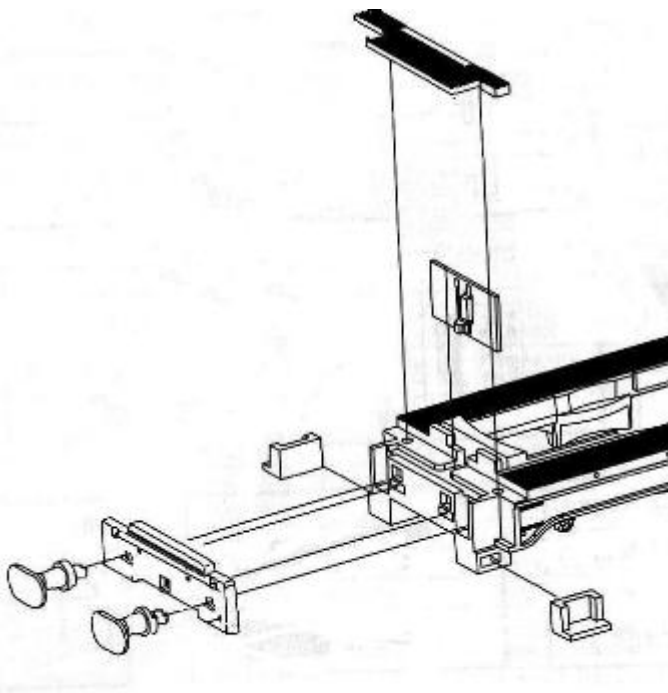

← This part is the SMD plate.

These parts will be fixed easily, with a very small amount of acrylic white glue or, if you wish to fix them permanently, with fast cyanoacrylate glue.

The included bogie roller bearing covers, will be glued in center of the rectangular original ones

The main body shell will fit the underframe the same way as the original, through the main screw. In the inner side, a cast column is already at place, just requiring drilling the fixing hole in the proper diameter.

4 - In this stage, the locomotive has improved it's final shape. After a track test run, it's time to full disassemble the moving powertrain, so that all paintwork may be done without contamination of all electrical and motion parts. A special care must be taken degreasing all parts before primer coating. Then, check the pattern for any finish imperfections that may require some putty filling and light abrasive sanding.

5-Now the required colors for the paint job:

Orange: Vallejo model color 70851 or RAL 2004

Brown : Vallejo model color 70872 or RAL 8017

Cabin interior: Yellow sand

The decals fit the brown/orange or the blue museum liveries of this locomotive, including all serial lettering.

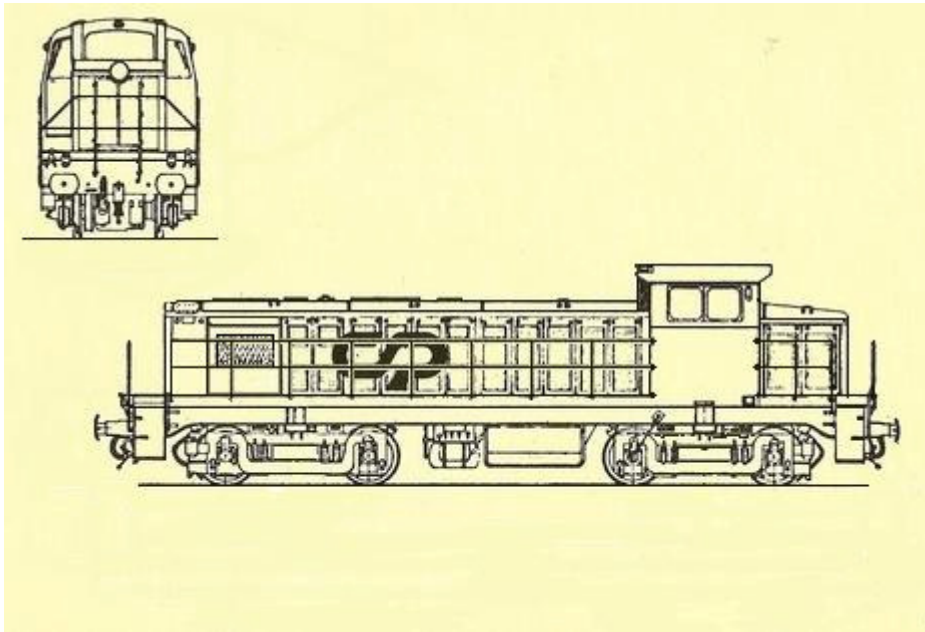

For further assistance, feel free to contact us. We will gladly help you

Nuno Rocha-Brito e André Rocha-Brito,

[www.arlo-micromodel.com](http://www.arlo-micromodel.com)

[micromodel.pt@gmail.com](mailto:micromodel.pt@gmail.com)